

# Swage Joint Sleeve

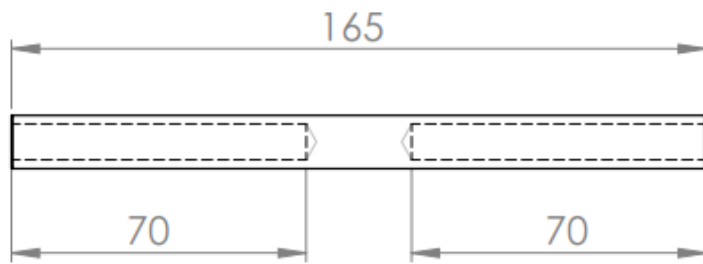

## Application

Swage joint sleeve used for cable jointing. Wire should be crimped inside hollow section with 5 no. 130kN swages on each end.

## Specification

|                        |                                |
|------------------------|--------------------------------|
| <b>Product code</b>    | FP-AC-CJ                       |
| <b>Material number</b> | 1501252                        |
| <b>Material</b>        | Stainless steel grade 316      |
| <b>Finish</b>          | Brushed                        |
| <b>Weight (kg)</b>     | 0.090                          |
| <b>Quality</b>         | ISO 9001                       |
| <b>Conformity</b>      | EN 795:2012, CEN/TS 16415:2013 |

The details stated are results of tests and/or calculations and therefore are non-binding and do not represent guarantees or warranted characteristics for not specified applications. All calculations therefore have to be checked and approved by the responsible planner ahead of execution. The user is responsible to assure compliance with all applicable laws and regulations.